

\$1,400,000 - 2629 Turtle Shores Dr # 103, Bloomfield Hills

MLS® #443345

\$1,400,000

Bedroom, Bathroom,
Lots/Land on 1.00 Acres

N/A, Bloomfield Hills, MI

Set along Turtle Lake's natural shoreline, this 1.085 acre lakefront site without wetlands, stunning topography and southern exposure is ideal for an estate size home. Enjoy bass fishing, kayaking, paddle boating and bird watching all within the gated, 24-hour guarded Turtle Lake community.

Essential Information

MLS® #	443345
Price	\$1,400,000
Acres	1.00
Type	Lots/Land
Sub-Type	Lots/Land

Community Information

Address	2629 Turtle Shores Dr # 103
Subdivision	N/A
City	Bloomfield Hills
County	Other
State	MI
Zip Code	48302

Amenities

Is Waterfront	Yes
---------------	-----

School Information

District	Other
----------	-------

Additional Information

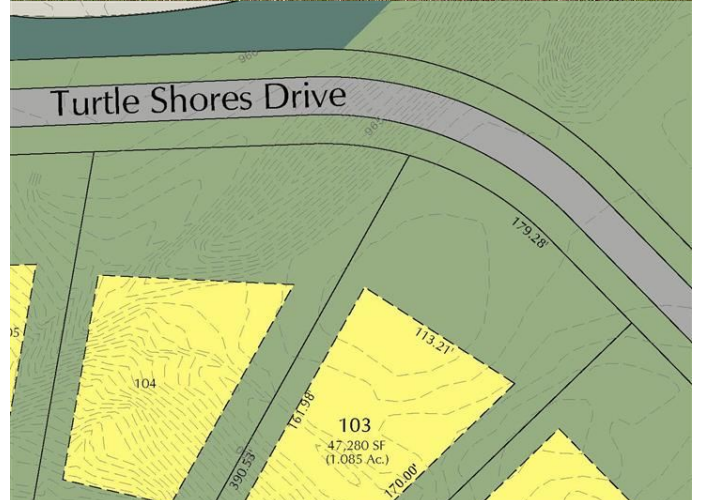

Zoning	Residential
HOA Fees	TBD
HOA Fees Freq.	TBD

Listing Details

This (property or listing) is courtesy of Harbor Sothebys International Realty

The data relating to real estate on this web site comes in part from the Internet Data Exchange Program of the Northern Michigan MLS (NM-MLSX). Real estate listings held by brokerage firms other than Kidd & Leavy Real Estate are marked with the NM-MLSX logo and the detailed information about said listing includes the listing office. All information deemed reliable but not guaranteed and should be independently verified. All properties are subject to prior sale, change or withdrawal. Neither the listing broker(s) nor Kidd & Leavy Real Estate shall be responsible for any typographical errors, misinformation, misprints, and shall be held totally harmless. Northern Michigan MLS, Inc © All rights reserved. IDX information is provided exclusively for consumers' personal, non-commercial use, that it may not be used for any purpose other than to identify prospective properties consumers may be interested in purchasing.